

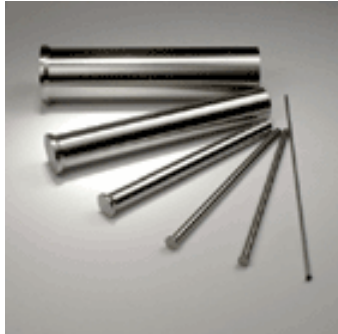

# ▶ CORTE Y ESTAMPADO

PUNZON CABEZA  
CONICA FORMA D  
ACERO WS / DIN 9861  
(CODIGO PW)

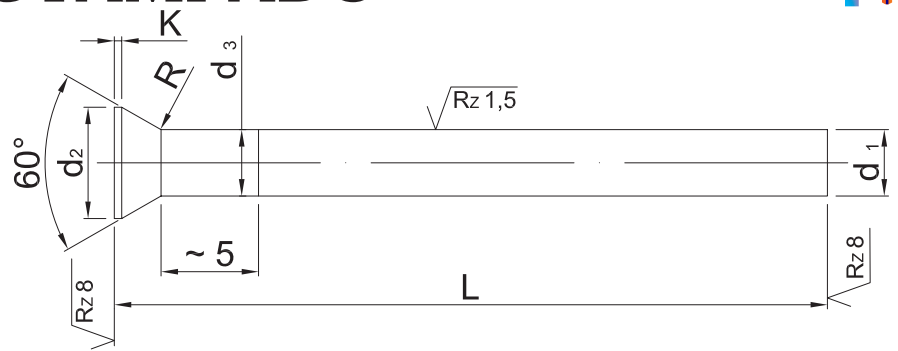

## ▶ CARACTERÍSTICAS

### Código Solicitud:

PW (d1xL)

**Acero:** WS: Acero al cromo  
Vanadio - Wolframio

**Largo:** Largo Standard:  
71 - 80 - 100 mm.

### Dureza

**Cuerpo:** 60/62 HRC

**Cabeza:** 45 ± 5 HRC

### Ejecución:

Rectificado - Lapeado

Cabeza recalada en caliente

Revestimiento TIN a pedido



d1 h6	d2	d3 max	K +0.2	L +0.5			
				71	80	100	
0.5	0.9	d1+0.02	0.2	●	●	●	
0.6	1.1			●	●	●	
0.7	1.3		0.4	●	●	●	
0.8	1.4			●	●	●	
0.9	1.6			●	●	●	
1.0/1.1	1.8	d1+0.03	0.5	●	●	●	
1.2/1.3	2.0			●	●	●	
1.4/1.5	2.2		0.5	●	●	●	
1.6/1.7	2.5			●	●	●	
1.8/1.9	2.8	d1+0.03	0.5	●	●	●	
2.0	3.0			●	●	●	
2.1/2.2	3.2			●	●	●	
2.3/2.5	3.5	d1+0.03	0.5	●	●	●	
2.6/2.9	4.0			●	●	●	
3.0/3.4	4.5			0.5	●	●	●
3.5/3.9	5.0				●	●	●
4.0/4.4	5.5	●	●		●		
4.5/4.9	6.0	d1+0.03	0.5	●	●	●	
5.0/5.4	6.5			●	●	●	
5.5/5.9	7.0			●	●	●	
6.0/6.4	8.0	d1+0.04	1.0	●	●	●	
6.5/7.4	9.0			●	●	●	
7.5/8.4	10.0			●	●	●	
8.5/9.4	11.0			●	●	●	
9.5/10.4	12.0	d1+0.04	1.0	●	●	●	
10.5/11.4	13.0			●	●	●	
11.5/12.4	14.0			●	●	●	
12.5/13.4	15.0			●	●	●	
13.5/14.4	16.0	d1+0.04	1.5	●	●	●	
14.5/15	17.0			●	●	●	
15.1/16	18.0			●	●	●	
16.1/17	19.0	d1+0.04	1.5	●	●	●	
17.1/18	20.0			●	●	●	
18.1/19	21.0			●	●	●	
19.1/20	22.0			●	●	●	
20.1/22	24.0			●	●	●	